

| No. of Contacts | DIMENSIONS |        | REMARK<br>(備註) |
|-----------------|------------|--------|----------------|
|                 | A          | B      |                |
| 4               | 2.54       | 5.08   | ○              |
| 6               | 5.08       | 7.62   | ○              |
| 8               | 7.62       | 10.16  | ○              |
| 10              | 10.16      | 12.70  | ○              |
| 12              | 12.70      | 15.24  | ○              |
| 14              | 15.24      | 17.78  | ○              |
| 16              | 17.78      | 20.32  | ○              |
| 18              | 20.32      | 22.86  | ○              |
| 20              | 22.86      | 25.40  | ○              |
| 22              | 25.40      | 27.94  | ○              |
| 24              | 27.94      | 30.48  | ○              |
| 26              | 30.48      | 33.02  | ○              |
| 28              | 33.02      | 35.56  | ○              |
| 30              | 35.56      | 38.10  | ○              |
| 32              | 38.10      | 40.64  | ○              |
| 34              | 40.64      | 43.18  | ○              |
| 36              | 43.18      | 45.72  | ○              |
| 38              | 45.72      | 48.26  | ○              |
| 40              | 48.26      | 50.80  | ○              |
| 42              | 50.80      | 53.34  | ○              |
| 44              | 53.34      | 55.88  | ○              |
| 46              | 55.88      | 58.42  | ○              |
| 48              | 58.42      | 60.96  | ○              |
| 50              | 60.96      | 63.50  | ○              |
| 52              | 63.50      | 66.04  | ○              |
| 54              | 66.04      | 68.58  | ○              |
| 56              | 68.58      | 71.12  | ○              |
| 58              | 71.12      | 73.66  | ○              |
| 60              | 73.66      | 76.20  | ○              |
| 62              | 76.20      | 78.74  | ○              |
| 64              | 78.74      | 81.28  | ○              |
| 66              | 81.28      | 83.82  | ○              |
| 68              | 83.82      | 86.36  | ○              |
| 70              | 86.36      | 88.90  | ○              |
| 72              | 88.90      | 91.44  | ○              |
| 74              | 91.44      | 93.98  | ○              |
| 76              | 93.98      | 96.52  | ○              |
| 78              | 96.52      | 99.06  | ○              |
| 80              | 99.06      | 101.60 | ○              |

PCFZ-XXR-X-030-M-\*  
 Number of Contacts  
 Right Angle  
 Contact Plating  
 NULL: PBT  
 F: Nylon-6T

**SPECIFICATIONS**  
 Current Rating: 3 Amps  
 Insulator resistance: 5000 Megohms min.  
 Contact resistance: 20 m ohms max.  
 Dielectric withstanding: AC 500 V  
 Operating Temperature: -40~+105°C  
 Contact Material: Phosphor Bronze  
 Insulator Material: Thermoplastic, UL 94V-0(PBT)  
 High Temperature Thermoplastic, UL 94V-0(Nylon-6T)  
 Color : Black

| Definition                            | Code |      |   |
|---------------------------------------|------|------|---|
| ◎ Tin plated:                         | A    |      |   |
| ◎ Gold plated:                        |      |      |   |
| flash                                 | B    | 15μ" | F |
| 10μ"                                  | E    | 30μ" | J |
| ◎ Duplex plating:                     |      |      |   |
| flash                                 | K    | 15μ" | P |
| 10μ"                                  | N    | 30μ" | U |
| ◎ Standard: B                         |      |      |   |
| ◎ Prefix "V" means lead free plating. |      |      |   |

Finish: Tin, Gold or Duplex plated  
 ◎ Standard: Gold plated all over

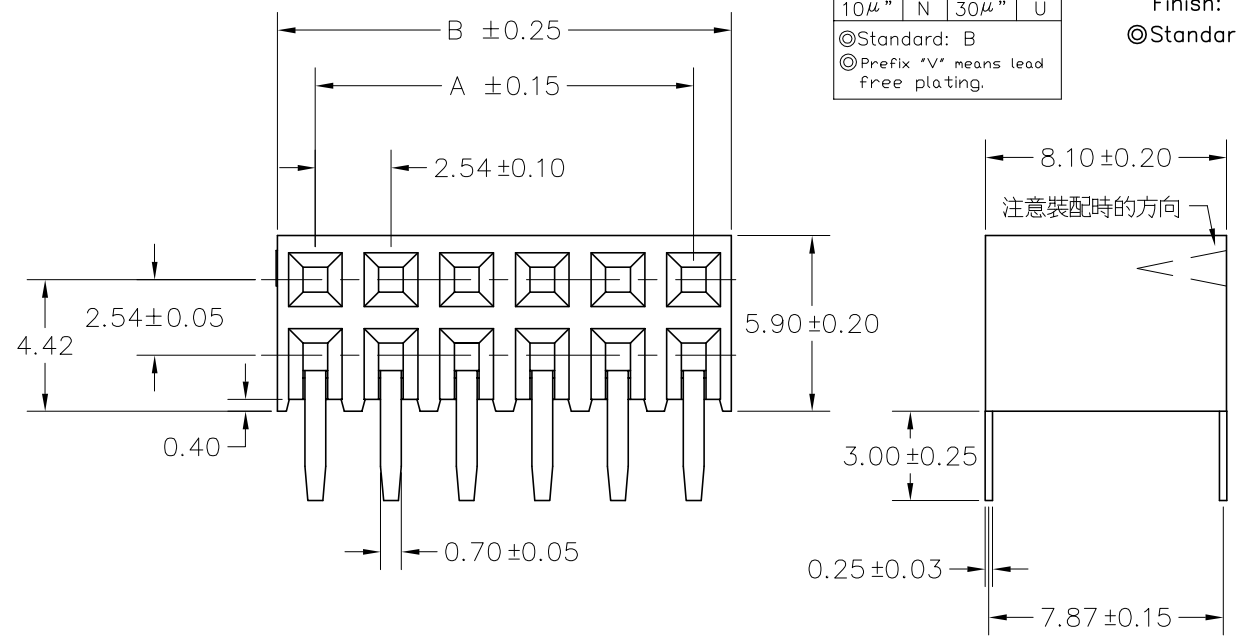

Recommended PCB Layout  
 (PCB TOLERANCE ± 0.05)

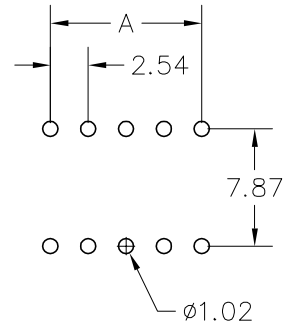

| Diagram | Molding description             |
|---------|---------------------------------|
| ○       | mass production & assemble mold |
| ◎       | sample & assemble mold          |
| ⊕       | mass production & fix mold      |
| ⊕       | sample & fix mold               |

| Rev. | ECN Number | Description   | Drawn | Date      |
|------|------------|---|-------|-----------|
| 3    | EC2-4B0047 | 新增環保電鍍選項  | 邱若婷   | 11/03 04' |
| 4    | EC2-4B0531 | 新增電鍍選項  | 洪銀雯   | 11/29 04' |
| 5    | EC2-4C0568 | 新增材質選項 修改料號<br>PCFZ-XXR-X-030-M->PCFZ-XXR-X-030-M-* | 洪銀雯   | 12/20 04' |



|   |  |           |                    |                |  |  |        |
|---|--|-----------|--------------------|----------------|--|--|--------|
| GENERAL TOLERANCE<br>XX. ± 0.50<br>X. ± 0.30<br>.X ± 0.25<br>.XX ± 0.20 | XXX. ±<br>.XXX ±<br>X.* ± 4°<br>.X* ± 4° | SCALE 1=1 | ORIGINAL DRAWN 林秋蘭 | DATE 20/03/01' | DWG. NO. X-XX<br>F:\DWG\CDWG\PCF\PCFZ0A.DWG<br>PARTS NO. △<br>PCFZ-XXR-X-030-M-* | TITLE 2.54mm SOCKET SIDE ENTRY (成品規格圖) | REV. 5 |
|   |  | UNIT MM   | CHECK 江坤容          | DATE 12/20 04' |  | SHEET 1/1                              |        |
|   |  | SIZE A4   | APPROVE 林錫錦        | DATE 12/20 04' |  |  |        |
|   |  |           |                    |                |  |  |        |