

XVRM8-40S-X-027-D

Pin type
 Brass
 Brass(reel)
 Phosphor Bronze
 ◎Standard: L

Number of Contacts

LP
 P
 Straight

Pin Length mm
 Contact Plating

Definition		Code	
◎ Tin plated:		A	
◎ Gold plated:			
flash	B	15μ"	F
10μ"	E	30μ"	J
◎ Duplex plating:			
flash	K	15μ"	P
10μ"	N	30μ"	U
◎ Standard: K			
◎ Prefix "V" means lead free plating.			

SPECIFICATIONS

Current Rating: 3 Amps
 Insulator resistance: 5000 Megohms min.
 Dielectric withstanding: AC 1000 V
 Operating Temperature: -40°~+105°C
 Contact Material: Copper alloy
 Insulator Material: High Temperature Thermoplastic, UL 94V-0(Nylon-6T)
 Color: Black

Finish: Tin, Gold or Duplex plated
 ◎ Standard: Duplex plated
 ◎ Note: Duplex plating: gold plated on contact area, Tin on solder area

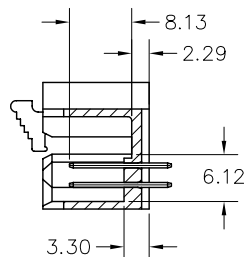
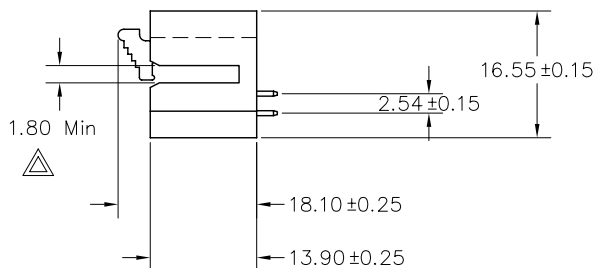
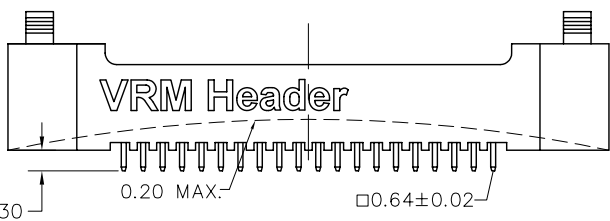
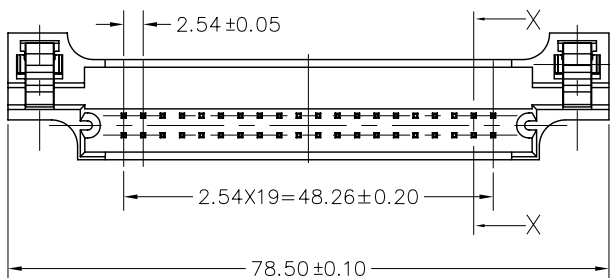
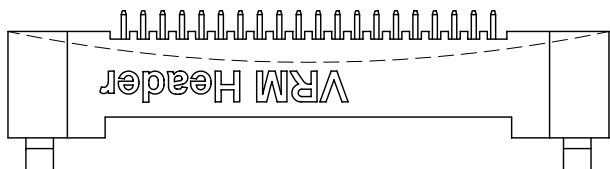

Recommended PCB Layout
 (PCB TOLERANCE ±0.05)

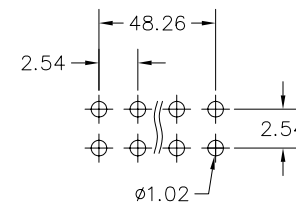

Rev.	ECN Number	Description	Drawn	Date
2	ECR-530167	變更料號 XVRM8-40S-X-027-D	陳美竹	03/28 05'
3	ECR-570020	新增 1.80 Min 控制尺寸	陳顯鑫	07/06 05'



GENERAL TOLERANCE		SCALE	1=1
XX. ± 0.50	XXX. ±	UNIT	MM
X. ± 0.30	.XXX ±	SIZE	A4
.X ± 0.25	X.° ± 4°		
.XX ± 0.20	.X° ± 4°		

ORIGINAL DRAWN	林秋蘭	DATE	05/11 03'
CHECK	林錫錦	DATE	07/06 05'
APPROVE	林錫錦	DATE	07/06 05'

DWG. NO.	X-XX	TITLE	成品規格圖	REV.	3
F:\DWG\CDWG\VRM\VRM80B.DWG				SHEET	1/1
PARTS NO.	XVRM8-40S-X-027-D				