

No. of Contacts	DIMENSIONS		REMARK (備註)
	A	C	
2	2.54	5.58	○
3	5.08	8.12	○
4	7.62	10.66	○
5	10.16	13.20	○
6	12.70	15.74	○
7	15.24	18.28	○
8	17.78	20.82	○
9	20.32	23.36	○
10	22.86	25.90	○
11	25.40	28.44	○
12	27.94	30.98	○
13	30.48	33.52	○
14	33.02	36.06	○
15	35.56	38.60	○
16	38.10	41.14	○
17	40.64	43.68	○
18	43.18	46.22	○
19	45.72	48.76	○
20	48.26	51.30	○
21	50.80	53.84	○
22	53.34	56.38	○
23	55.88	58.92	○
24	58.42	61.46	○
25	60.96	64.00	○
26	63.50	66.54	○
27	66.04	69.08	○
28	68.58	71.62	○
29	71.12	74.16	○
30	73.66	76.70	○
31	76.20	79.24	○
32	78.74	81.78	○
33	81.28	84.32	○
34	83.82	86.86	○
35	86.36	89.40	○
36	88.90	91.94	○
37	91.44	94.48	○
38	93.98	97.02	○
39	96.52	99.56	○
40	99.06	102.10	○

PHFY-XXS-X-B-*
 Number of Contacts Straight
 NULL: P.BT
 F: Nylon -6T

Contact Plating

Definition	Code
◎ Tin plated:	A
◎ Gold plated:	
flash	B 15m" F
10m"	E 30m" J
◎ Duplex plating:	
flash	K 15m" P
10m"	N 30m" U
◎ Standard: B	
◎ Prefix "V" means lead free plating.	

SPECIFICATIONS

Current Rating: 3 Amps
 Insulator resistance: 5000 Megohms min.
 Contact resistance: 20 m ohms max.
 Dielectric withstanding: AC 1000 V
 Operating Temperature: -40~+105°C
 Contact Material: Phosphor Bronze.
 Insulator Material: Polyester, UL 94V-0

Finish: Tin, Gold or Duplex plated
 ◎ Standard: Gold flash all over
 ◎ Note: Duplex plating: gold plated on contact area, Tin on solder area

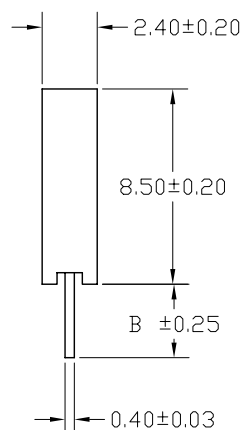
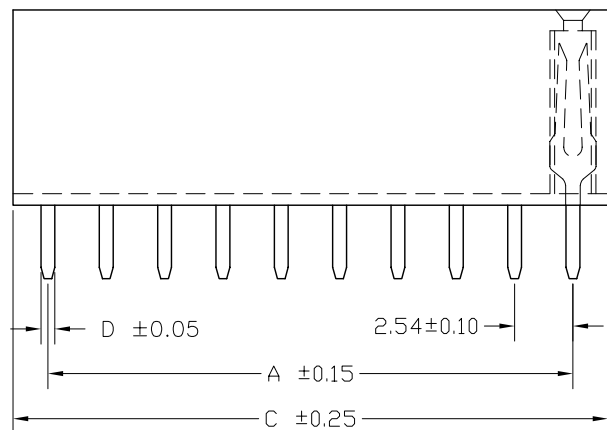
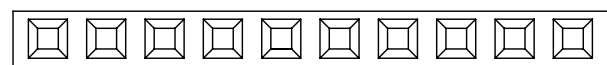

Recommended PCB Layout
 (PCB TOLERANCE ±0.05)

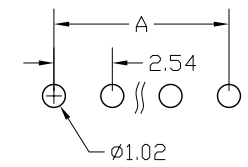

B	D
3.20	0.64
6.00	0.76
11.00	0.76

Diagram	Molding description
○	mass production & assemble mold
◎	sample & assemble mold
⊕	mass production & fix mold
⊕	sample & fix mold

Rev.	ECN Number	Description	Drawn	Date
2	EC2-480038	新增無鉛電鍍說明	陳美竹	08/04/04'
3	ECR-590008	新增耐高溫材質	陳美竹	09/05 05'



GENERAL TOLERANCE	
XX. ± 0.50	XXX. ±
X. ± 0.30	.XXX ±
.X ± 0.25	.X° ± 4'
.XX ± 0.20	.X° ± 4'

SCALE 1=1	UNIT MM	SIZE A4
-----------	---------	---------

ORIGINAL DRAWN 陳美竹
 CHECK 林錫錦
 APPROVE 林錫錦

DATE 03/10/02
 DATE 09/05 05'
 DATE 09/05 05'

DWG. NO. 3-19
 F:\DWG\CDWG\PHF\PHFYSOC.DWG
 PARTS NO. PHFY-XXS-X-B-*

TITLE 2.54mm SOCKET SIDE ENTRY TYPE (成品規格圖)

REV. 3
 SHEET 1/1